

Benchmark

Economy

Machine type:	Maschinentyp:
Clamping system	Schließsystem
Tie bar arrangement	Zugankeranordnung
EUROMAP size indication *1	EUROMAP Größenangabe *1
Injection unit - standard size	Spritzeinheit - Standardgröße Nr.
Injection unit - option size	Spritzeinheit - Optionsgröße Nr.
Injection unit - size:	Spritzeinheit - Größe: Nr.
Injection piston diameter	Spritzkolbendurchmesser mm
Injection pressure	Einspritzdruck bar
Injection volume	Hubvolumen cm³
Piston stroke	Kolbenhub mm
Injection force	Spritzkraft kN
Injection volume, calc.*1	Einspritzstrom, rechn.*1 cm³/s
Screw diameter	Schneckendurchmesser mm
Screw length	Schneckenlänge L : D
Screw speed	Schneckenrehzahl U/min.
Screw torque, max.	Schneckenrehmoment, max. Nm
Heating capacity temp. control	Heizleistung - Temperierung kW
Injection unit contact force	Düsenanpresskraft kN
Strip width	Streifenbreite mm
Clamping unit	Schließeinheit
Clamping force	Schließkraft kN
Transfer force	Transferkraft kN
Transfer stroke	Transferhub mm
Opening force	Öffnungskraft kN
Opening stroke	Werkzeugöffnungsweg mm
Opening speed	Öffnungsgeschwindigkeit mm/s
Closing speed	Schließgeschwindigkeit mm/s
Mould height, min.	Werkzeugeinbauhöhe, min. mm
Space bet. heating pl., max. *1	Plattenabstand, max. *1 mm
Clearance between tie bars	Lichter Säulenabstand mm
Heating platen, standard	Heizplatten Standard mm
Hydraulic lifting device	Hydr. Hebevorrichtung
Lifting force	Hubkraft kN
Stroke	Hub mm
Central ejector	Zentralauswerfer
Lifting force	Hubkraft kN
Stroke	Hub mm
General data	Allgemeine Daten
Pump drive	Pumpenantrieb bar
	l/min
	K W
Total connected load	Gesamtanschlusswert kW
Machine dimension LxWxH, *1	Maschinenmaße LxBxH, *1 mm
Oil tank capacity	Öltankfüllung l
Weight with hydr.oil, *1	Gewicht mit Hydrauliköl, *1 kg

968.250 ZO B750	968.400 ZO B750	968.560 ZO B750
full-hydr. vollhydr.	full-hydr. vollhydr.	full-hydr. vollhydr.
2500-3400	4000 - 7000	5600 - 10 000
3A	4A	5A
2A and und 4A	3A and und 5A	4A and und 6A
1A	4A	
85 95	105 115	115 125
2150 1730	2150 1800	2060 1740
1600 2000	3300 4000	5000 6000
290	390	490
1227	1886	2100
120 150	190 230	205 245
45	55	65
10:1	10:1	10 : 1
20 - 160	20 - 200	20 - 150
1260	1370	1940
2 x 4,5	2 x 4,5	3 x 4,5
125	125	125
60 x 8	60 x 10	70 x 12
2500 (2700)	4000 (4500) *2	5600 (6300)
2500	4000	5600
full-hydr. vollhydr.	full-hydr. vollhydr.	full-hydr. vollhydr.
57	93	94
500 - 800	500 - 830	500 - 910
450	460	450
650	650	450
160	180	180
960	1010	1090
510 x 680	603 x 830	683 x 950
560 x 630	670 x 780	810 x 980
79 / 49, 38 / 63	76 / 125, 58 / 98	76 / 125, 58 / 98
0 - 250	0 - 400	0 - 400
-	-	-
-	-	-
250 (265)	251 (283)	253 (285)
65	103	103
22	30	30
49	70	90
1690 x 2860 x 3430	3170 x 1740 x 3660	3500 x 1740 x 4010
250	300 / 450	300 / 450
9600	13900 / 14900	19400 / 20400

968.160 ZO E	968.250 ZO E
full-hydr. vollhydr.	full-hydr. vollhydr.
1600 - 1700	2500 - 3400
2C / 2A	3A
1C / 1A + 3A	2C / 2A + 4A
75 85	85 95
2150 1670	2150 1730
800 1000	1600 2000
75	85
2150	1670
55 / 80 75 / 100	120 150
35	45
11 : 1 / 10 : 1	10 : 1
20 - 175 / 20 - 250	20 - 160
540	1260
1 x 4,5 / 2 x 4,5	2 x 4,5
- / 78	125
45 x 7	60 x 8
1600 (1700)	2500 (2700)
1600	2500
full-hydr. vollhydr.	full-hydr. vollhydr.
58	80
500	550
300	220
420	280
140	160
640	710
410 x 570	510 x 680
450 x 510	560 x 630
40	63
0 - 250	0 - 250
-	-
-	-
260 (276)	250 (265)
28	41
7,5	15
22	38
2350 x 1515 x 3150	2565 x 1550 x 3500
150	150
4200	8000

*1 Standard size | Standardgröße *2 Clamping force increase | Schließkrafterhöhung
*3 Independent of mould height | Unabhängig von der Werkzeugdicke

Vertical series | Baureihen Vertikal:
Benchmark
Economy
DESMA 968 ZO
DESMA 968 T
Horizontal series | Baureihe Horizontal:
DESMA 969 Z

DESMA. The world leader
in turnkey rubber injection
moulding technology.

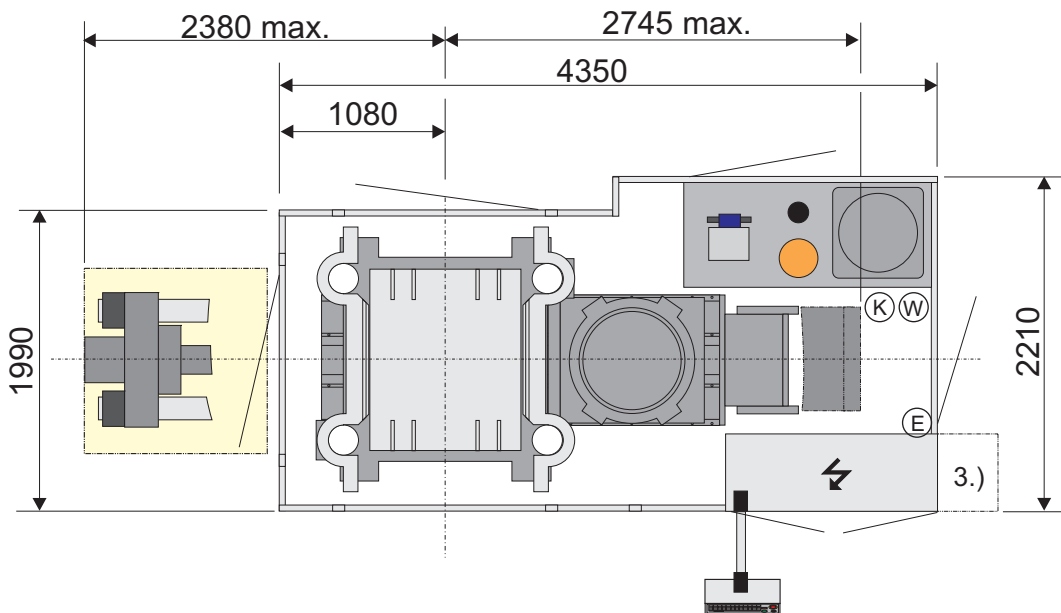
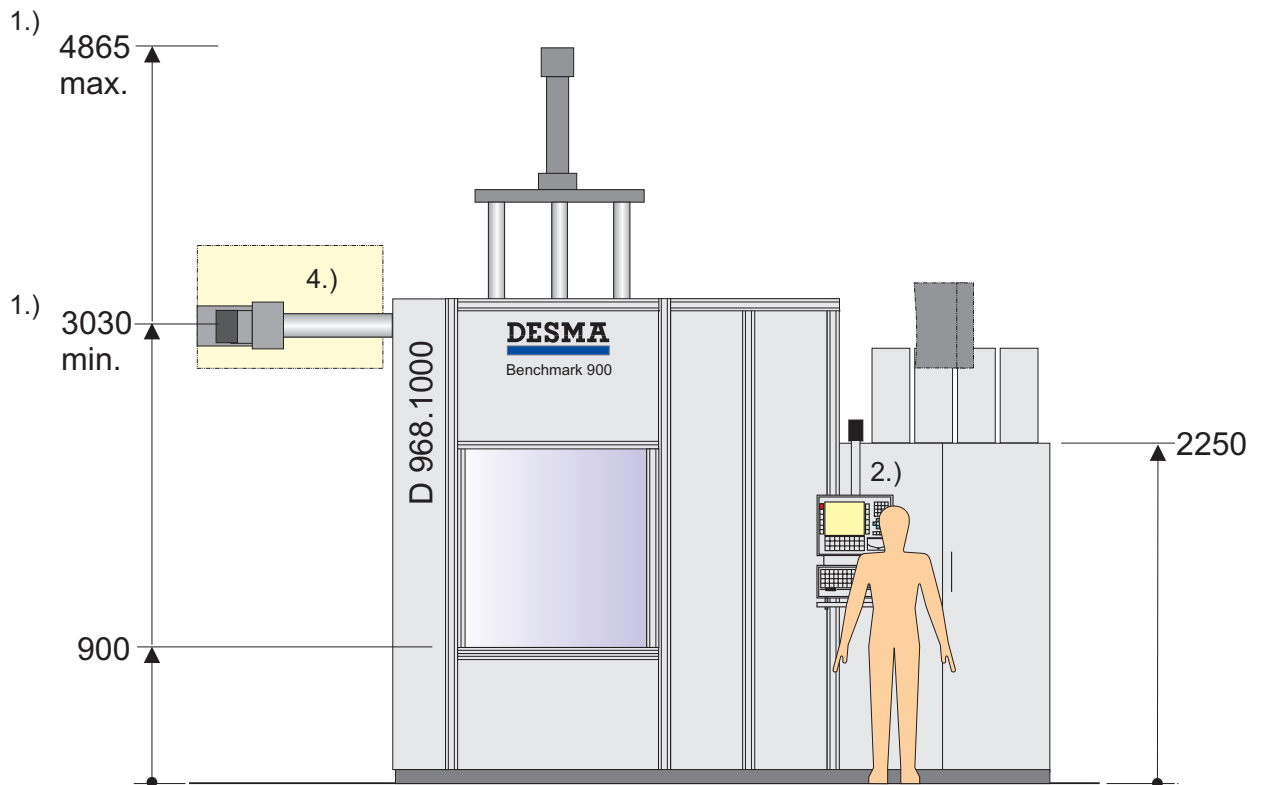

- 1.) Bei Zugankerverlängerung +150/+300mm
- 2.) Lage und Ausführung steuerungsabhängig
- 3.) Bei verstärktem Hauptstrombereich Verlängerung um 200-400mm

- 4.) Gefahrenbereich: keine Gegenstände unterstellen.
Quetschgefahr zwischen Gegenständen und Hubbewegung der Einspritzeinheit.

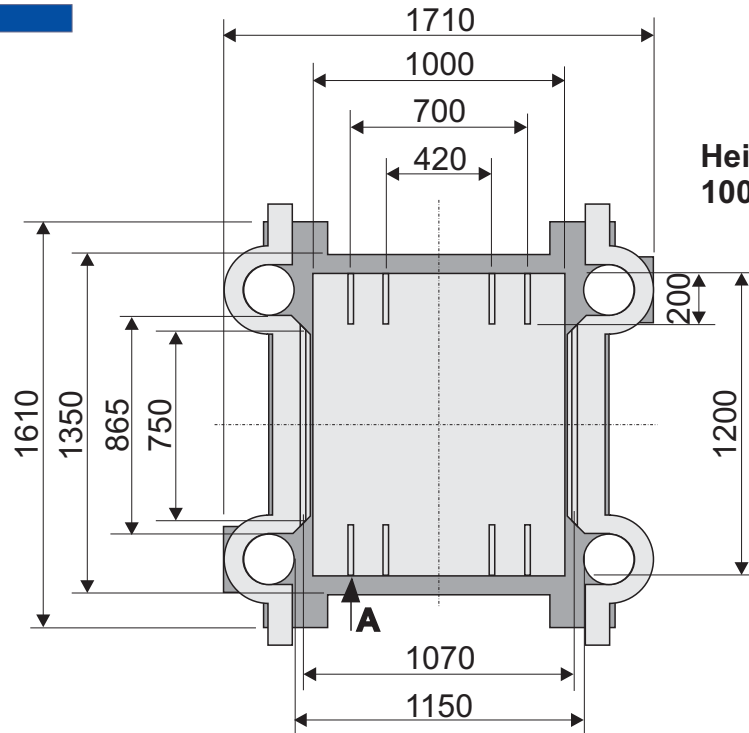

Heizplatte, standard
1000x1200mm

Detail A

DIN 650 (ISO 299)

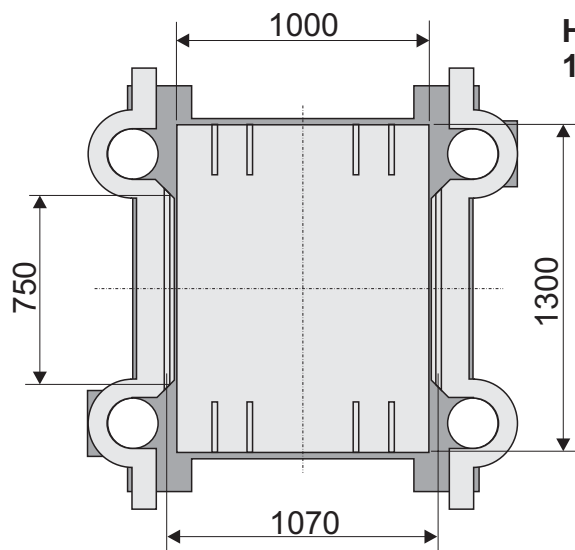
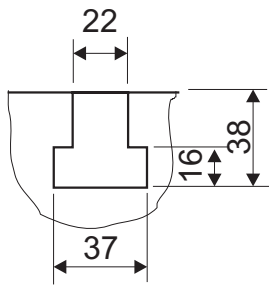

Heizplatte, verlängert
1000x1300mm

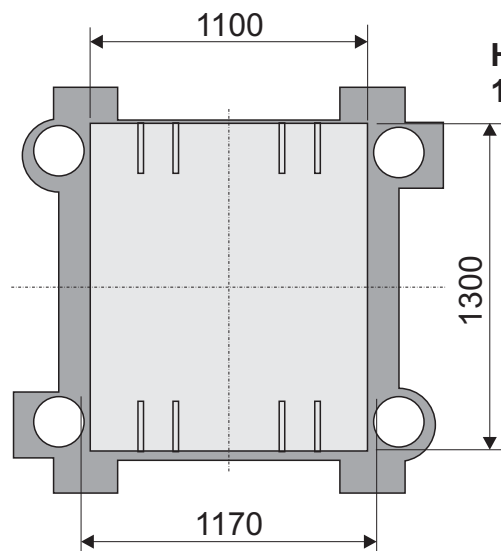

Heizplatte, vergrößert
1100x1300mm

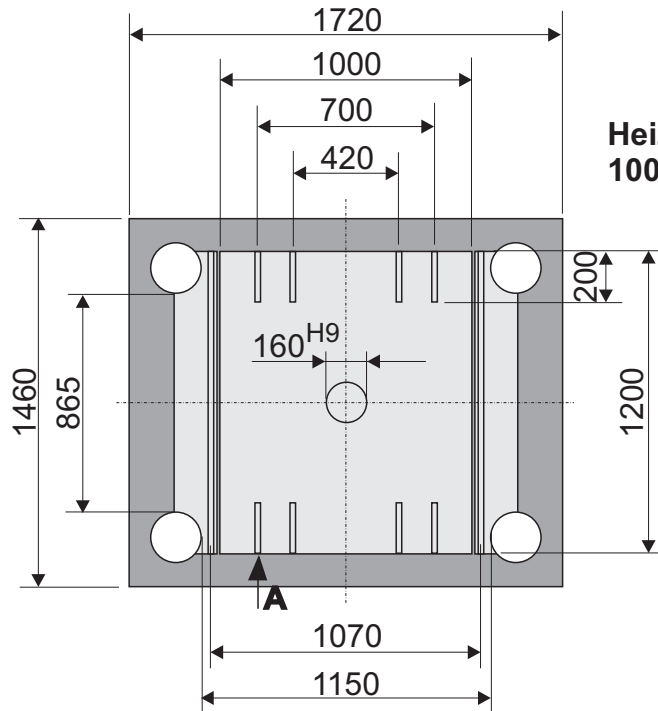

Detail A
DIN 650 (ISO 299)

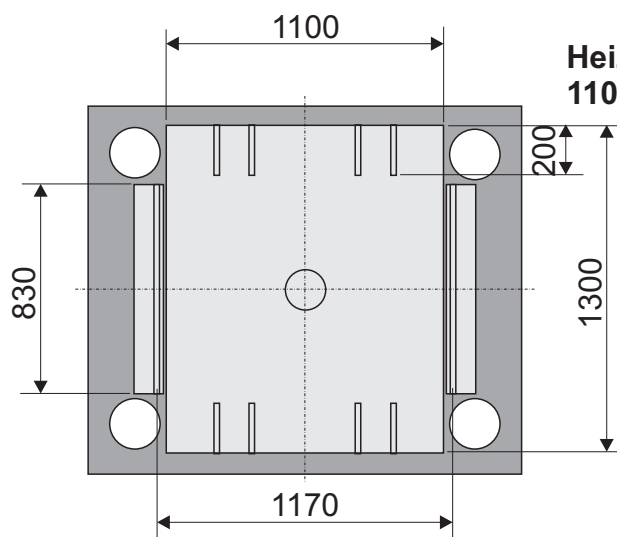
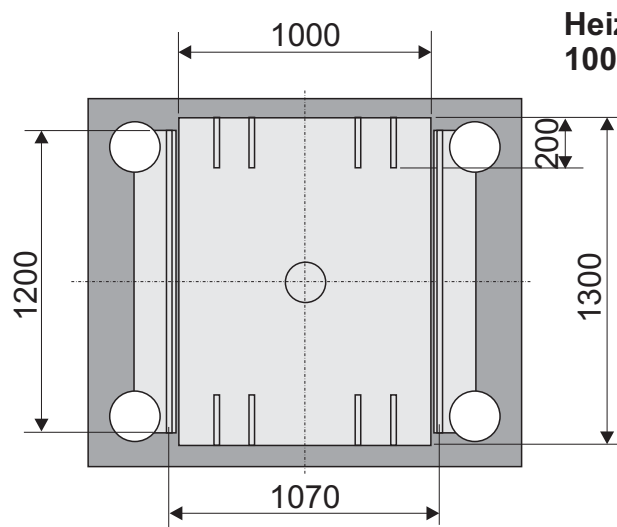
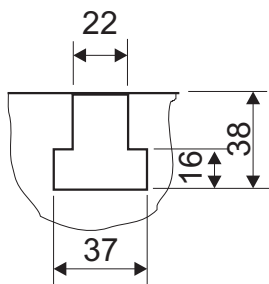

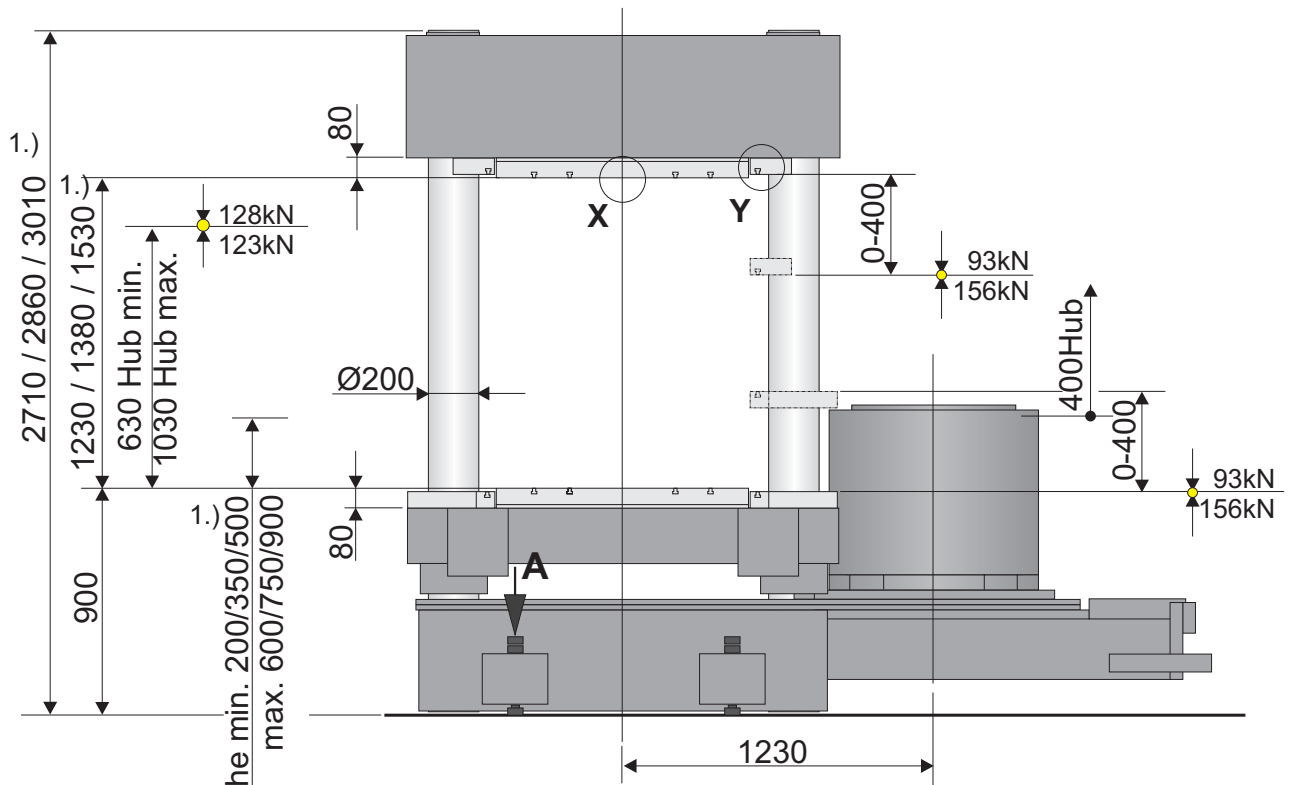

Formenhöhe min. 200/350/500
max. 600/750/900

Detail A

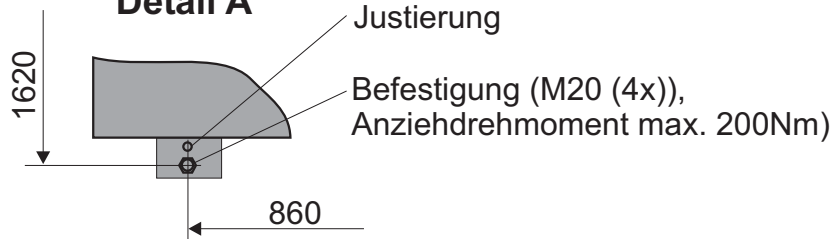

Detail X

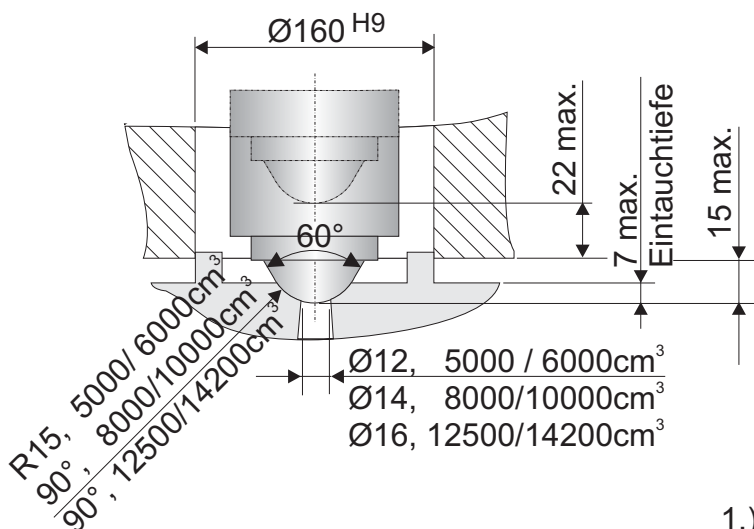

Detail Y DIN650(ISO299)

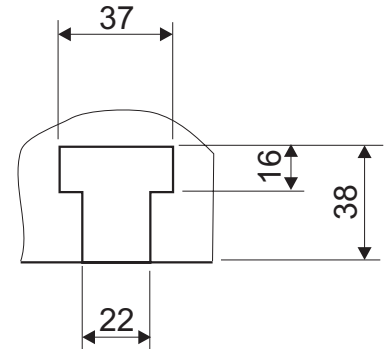

1.) Zugankerverlängerung +150 / +300mm

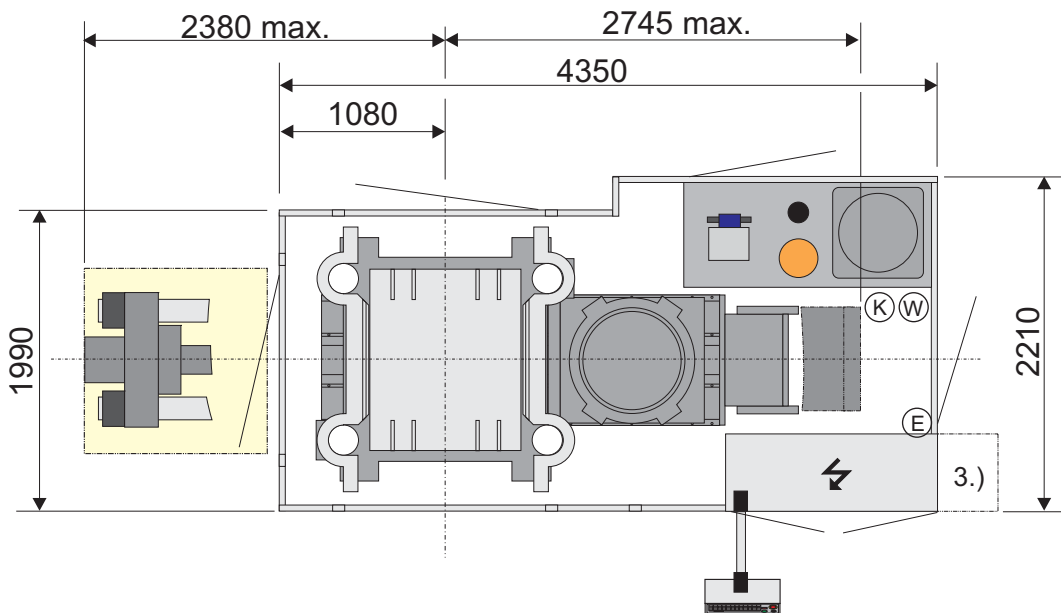
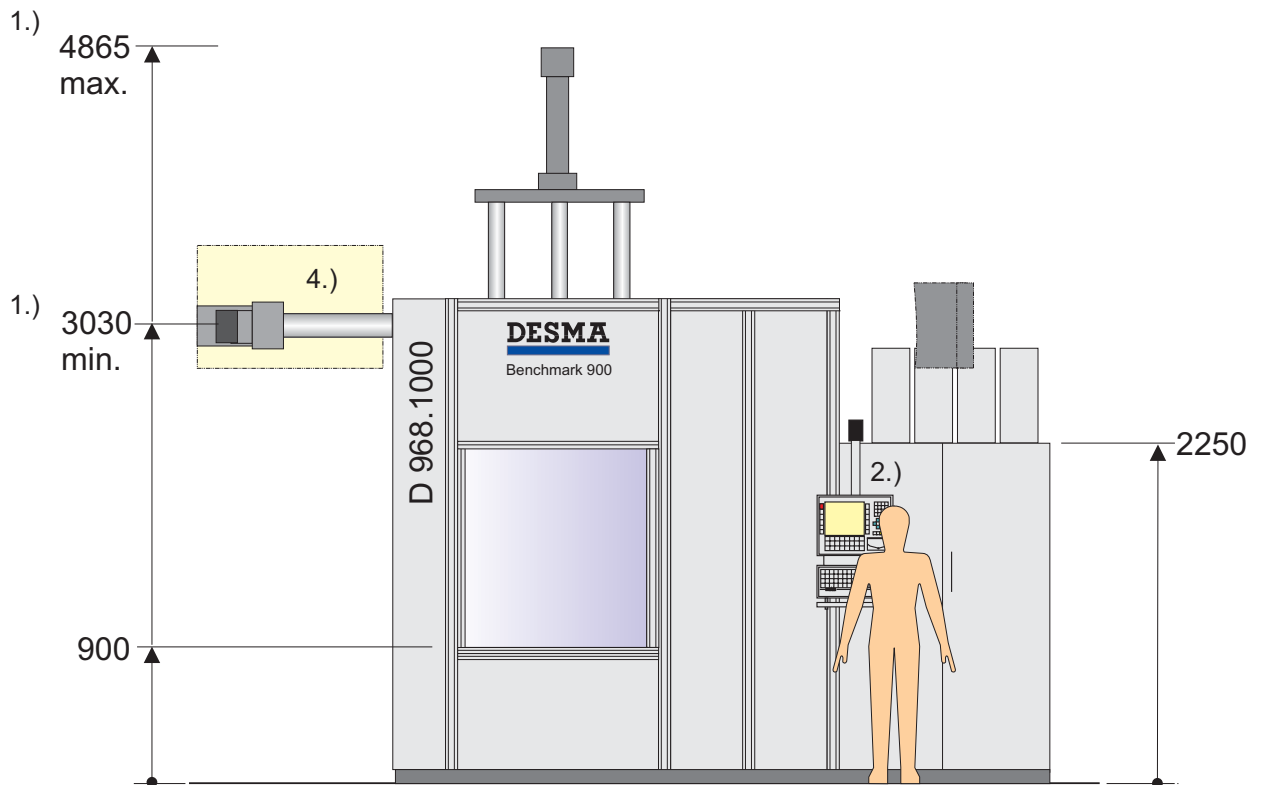

- 1.) Standard tie rod extension +150/+300mm
 2.) Position and execution depending on control system
 3.) Extension by 200-400mm in case of reinforced main current area

- 4.) Danger area: Do not place any objects underneath.
 Bruise hazard between objects and stroke movement of injection unit.

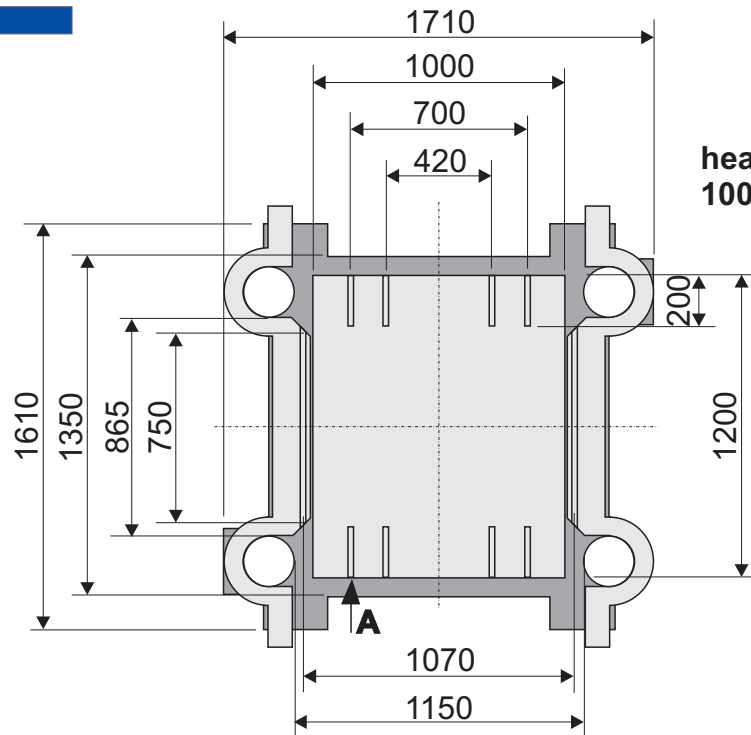

heating plate, standard
1000x1200mm

Detail A

DIN 650 (ISO 299)

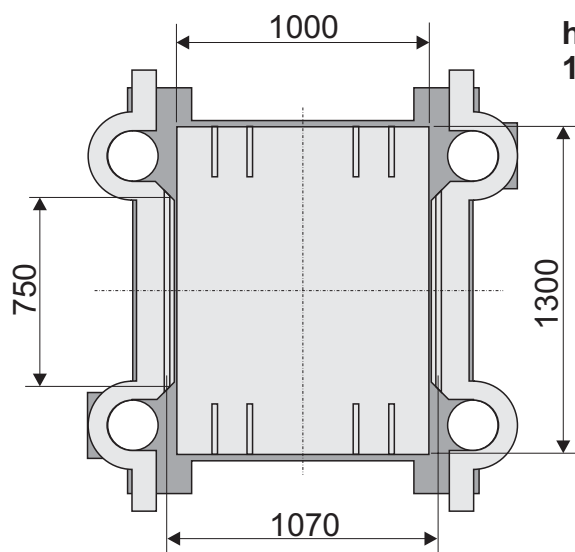
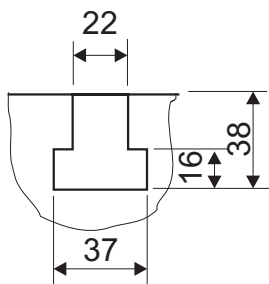

heating plate, longer
1000x1300mm

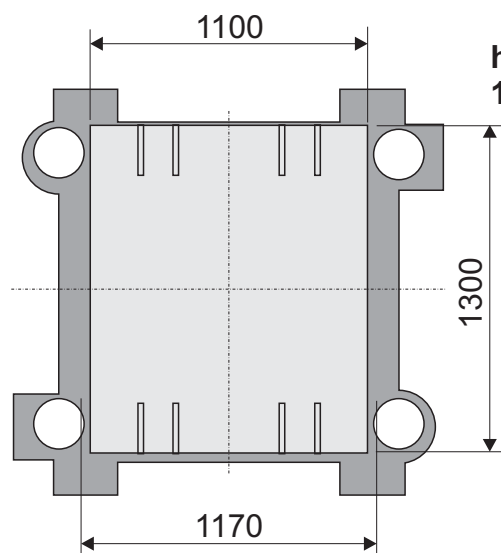

heating plate, larger
1100x1300mm

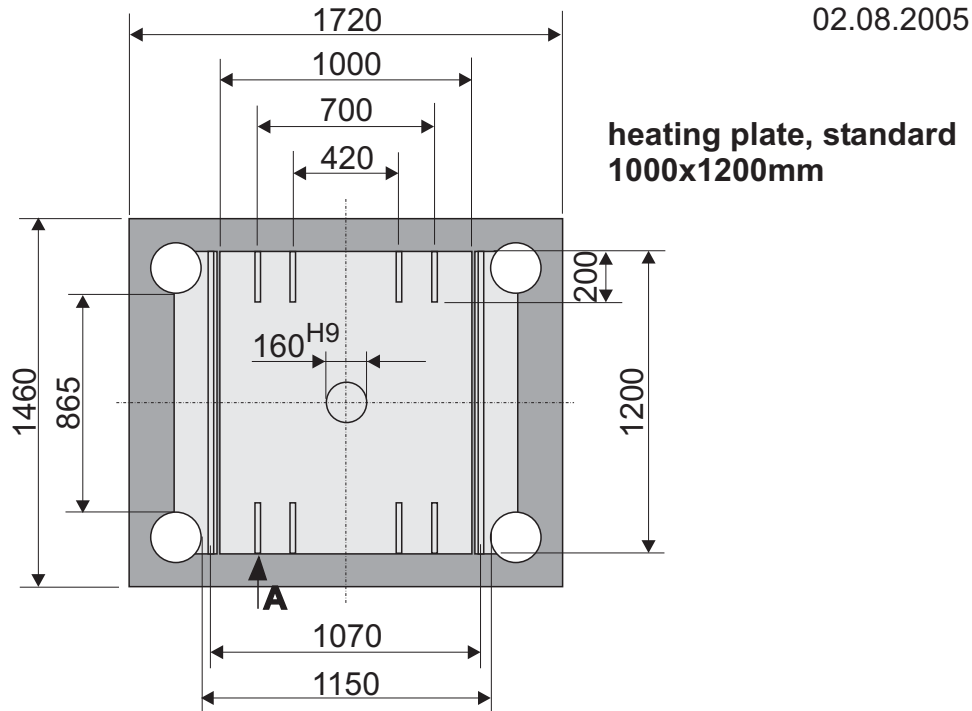

Detail A
DIN 650 (ISO 299)

